

# INDUSTRIAL SAND BLAST KIT

## Component Listing

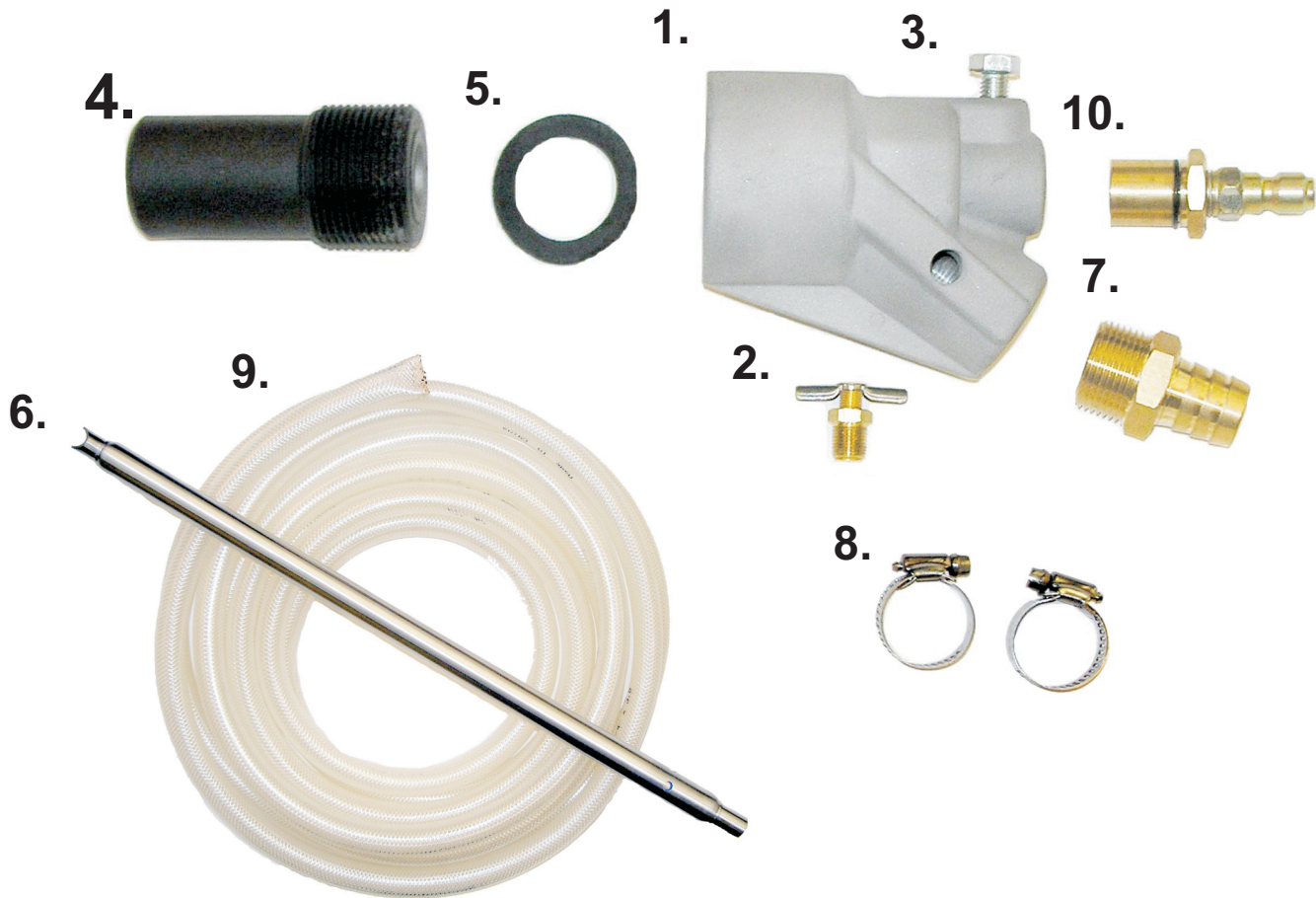

Num.	Item	Description
1.	16.0118	Sand Blast Head
2.	16.0119	Sand Valve 1/8 MPT
3.	16.0120	Nozzle Holder Retaining Bolt
4.	16.0121	Tungsten Carbide Nozzle & Body
5.	16.0123	Gasket
6.	16.0124	Sand Probe
7.	16.0125	Hose Barb Brass 3/4
8.	16.0126	Hose Clamp 3/4 (qty 2)
9.	16.0127	Clear PVC Nylon braid Hose 3/4 x 25'
10.	16.0128	Nozzle Holder 1/4 QC Inlet x 1/4 fpt Outlet

components and accessories for high pressure cleaners and car wash industry

***USER MANUAL***

**PROFESSIONAL SAND BLAST KIT**

<b>Removal of:</b>	<b>Sand Mesh</b>	<b>Sand Type</b>	<b>Blasting Angle</b>
<b>Paint from Metal</b>	<b>20/40</b>	<b>Round Silica</b>	<b>0 - 30</b>
<b>Paint from Masonry</b>	<b>20/40</b>	<b>Round Silica</b>	<b>0 - 20</b>
<b>Rubber Base Paint from Masonry</b>	<b>10/35</b>	<b>Angular</b>	<b>0 - 15</b>
<b>Paint Base Wood (coarse, rough cut effect)</b>	<b>40/60</b>	<b>Round</b>	<b>1 - 10</b>
<b>Paint from Wood (smoother, driftwood effect)</b>	<b>20/40</b>	<b>Round</b>	<b>1 - 10</b>
<b>Metal Scale</b>	<b>20/40</b>	<b>Round</b>	<b>0 - 15</b>
<b>Rust</b>	<b>16/50</b>	<b>Angular</b>	<b>0 - 15</b>

# INDUSTRIAL SAND BLAST KIT

## ASSEMBLY/OPERATING INSTRUCTIONS

Always wear protective clothing, including safety glasses while the unit..

Install Item #4 securely in the front of Item #1.

Install appropriate size ¼ threaded spray nozzle (not included) in item # 10.

Securely install item #10 in rear of item #1 lock item #10 in place using item #3.

Install item #2 in side port of item #1.

Install Item #7 in bottom port of item #1.

Connect item #6 & #7 to each end of item #9. Secure item # 9 in place with the clamps provided (#8).

Place the sand induction probe in the sand supply container.

Connect the mixing head to the spray wand. Start the pressure washer per the manufacturer's instruction.

Trigger the spray gun to activate the spray. Check the distance to hold the spray nozzle from the surface by starting from a distance of several

feet. Gradually move closer, checking frequently to see the results of the high pressure spray on the surface. Stop when desired cleaning occurs moving closer to the surface could result in the high pressure spray causing damage to the surface.

Always point the sand nozzle downward when not spraying. This will prevent water from entering the sand supply.

If water does get into the sand supply hose, remove the probe from the sand, hold the spray gun trigger open, and let the hose air dry. Always be sure the sand hose is dry before using.

Keep the sand covered to prevent the over spray from wetting the sand. Do not allow small fragments of the sand bag to mix into the sand supply. A small bag fragment could interrupt the flow of sand.

After the sandblasting operation is complete, remove the probe from the sand, hold the spray gun trigger open to clear the hose and probe of sand. Then remove the hose from the sand blast head and rinse with water to remove all the sand before storage.